

Pipe Hole Cutter

JK150

Product Description

- The Hongli Model JK150 pipe hole cutter is designed to cut holes up to 152mm into steel pipe. The multiple hole sizes allow the use of Mechanical fittings for branching unpressurized pipe lines.
- The JK150 has a 5/8" (16mm) capacity drill chuck to accommodate all sizes of hole saws and hole saw arbors. An integral motor and gear reduction optimizes performance of large diameter hole saws. The two feed handles allows the operator to use the Hole Cutting Tool from either the left or right side.



Specifications

- Cutting Capacity: Up to 6" (152 mm)
- Pipe Mounting Capacity: 1 1/4" - 12" (30mm-300 mm)
- Drill Chuck Capacity: 3-16mm
- Drill Chuck Speed: 110 RPM (no load)
- Motor: universal, 1500W
- Height: 303mm
- Length: 340mm
- Width: 315mm



Ordering Information

Catalog No.	Model No.	Description	N.W
85002	JK150	Pipe hole cutter 110V-60Hz	20kg
85001	JK150	Pipe hole cutter 220V-50Hz	20kg

JK114

Product Description

- Model JK114 is designed for pipe hole cutting up to 114mm into steel pipe. The multiple hole sizes allow the use of Mechanical fittings for branching unpressurized pipe lines.
- Light weight for easy transportation, ideal for the hole cutting in small sizes. Induction motor ensures quiet working performance.

Specifications

- Cutting Capacity: up to 4" (114mm)
- Pipe Mounting Capacity: 1 1/4"-8" (32mm-220mm)
- Drill Chuck Capacity: 3-16mm
- Drill Chuck Speed: 110RPM (no load)
- Motor: induction, 550W
- Height: 513mm
- Length: 260mm
- Width: 248mm

Ordering Information

Catalog No.	Model No.	Description	N.W
84001	JK114	Pipe hole cutter 110V-60Hz	14.8kg
84002	JK114	Pipe hole cutter 220V-50Hz	14.8kg



Hole saws



arbor

Product Description

- Excellent performance and long-lasting life.
- Bi-metal construction with teeth made from specially hardened M3 or M42 high speed steel. The varying teeth height and gullet sizes result in much faster cutting and longer life. Suitable for various material like mild steel, tool and stainless steel, brass, aluminum, wood. Size ranges from 14mm to 210mm.
- Depth of cut: 38mm
- Use high quality thread cutting oil on all metal except cast iron



Ordering Information

Model No.	Sizes (mm)	Applicable arbor
H14	14	A1
H16	16	A1
H17	17	A1
H19	19	A1
H20	20	A1
H21	21	A1
H22	22	A1
H24	24	A1
H25	25	A1
H27	27	A1
H29	29	A1
H30	30	A1
H32	32	B1
H33	33	B1
H35	35	B1
H37	37	B1
H38	38	B1
H40	40	B1
H41	41	B1
H43	43	B1

Model No.	Sizes (mm)	Applicable arbor
H44	44	B1
H46	46	B1
H48	48	B1
H51	51	B1
H52	52	B1
H54	54	B1
H57	57	B1
H59	59	B1
H60	60	B1
H64	64	B1
H65	65	B1
H67	67	B1
H68	68	B1
H70	70	B1
H73	73	B1
H76	76	B1
H79	79	B1
H83	83	B1
H86	86	B1
H89	89	B1

Model No.	Sizes (mm)	Applicable arbor
H92	92	B1
H95	95	B1
H98	98	B1
H102	102	B1
H105	105	B1
H108	108	B1
H111	111	B1
H114	114	B1
H121	121	B1
H127	127	B1
H133	133	B1
H140	140	B1
H146	146	B1
H152	152	B1
H160	160	B1
H165	165	B1
H168	168	B1
H177	177	B1
H200	200	B1
H210	210	B1

Hydraulic Power Pipe Cutters

Product Description

- The Model QG8C Hydraulic Power Pipe Cutter cuts 2" to 8" schedule 10/40, steel pipe, galvanized pipe at the job site or in the shop. The operator controls the feeding rate by pumping the hydraulic hand pump throughout the operation. The QG8C cuts pipes with clean cutting edge, no sparks, dust or open flame. The processed pipes can be threaded or grooved with no extra processing. An induction motor ensures very quiet operation.

Features

- Easily cuts by displacing instead of removing pipe material.
- No abrasive dust, dangerous sparks, or open flame.
- Quickly cuts steel pipe with minimal burr.
- Great for cutting pipe for groove joining.
- Heavy-duty design is perfect for field or shop use.
- Quiet operation.

Specifications

- Cutting Capacity: 2" to 8" schedule 10/40
- Motor: 450W induction, 50/60Hz
- Spindle Speed: 24 RPM
- Switch: ON/OFF heavy duty switch

Ordering Information

Catalog No.	Model No.	Description	N.W(kg)
75003	QG8C	Hydraulic Power Pipe Cutter, 110V/60Hz	65
75001	QG8C	Hydraulic Power Pipe Cutter, 220V/50Hz	65
Accessories			
	--	Cutting Wheel	
	--	Ball Bearing Pipe Support for QG8C	6



Ball Bearing Pipe Support for QG8C

QG8C



Model QG8C Hydraulic Power Pipe Cutter



Cutting, Drilling and Beveling

QG12C

Product Description

- The Model QG12C Hydraulic Power Pipe Cutter offers 2½" to 12" schedule 10/40 cutting range. Utilizing displacement type cutter wheel technology. The operator controls the feeding rate by pumping the hydraulic hand pump throughout the operation. The QG12C cut pipes with clean cutting edge, no sparks, dust or open flame. The processed pipes can be threaded or grooved with no extra processing. An induction motor ensures very quiet operation.

Features

- Easily cuts by displacing instead of removing pipe material.
- No abrasive dust, dangerous sparks, or open flame.
- Quickly cuts steel pipe with minimal burr.
- Great for cutting pipe for groove joining.
- Heavy-duty design is perfect for field or shop use.
- Quiet operation.

Specifications

- Cutting Capacity: 2½" to 12" schedule 10/40
- Motor: 750W induction, 50/60Hz
- Spindle Speed: 24 RPM
- Switch: ON/OFF heavy duty switch

Ordering Information

Catalog No.	Model No.	Description	N.W(kg)
76003	QG12C	Hydraulic Power Pipe Cutter, 110V/60Hz	120
76001	QG12C	Hydraulic Power Pipe Cutter, 220V/50Hz	120
Accessories			
	--	Cutting Wheel	
4021010	--	Ball Bearing Pipe Support for QG12	11



Model QG12C Hydraulic Power Pipe Cutter



Ball Bearing Pipe Support for QG12C

C-Narrow Design Pipe Beveling Machine



Product Description

- This machine is effective, ideal and reliable solution to precisely square cut and bevel for all types of metal pipes/tubes. All saw-bladed pipe cutters with precise, square and clean cut, which save any additional preparation work on the cut-off face for orbital welding.
- The cut/beveled pipe is free from burr and deformation because of high quality saw blades. It is the best choice for direct S.S pipe welding on catering, pharmacy, semiconductor optoelectronics, biology, chemical industry, oil and gas, water treatment, shipbuilding, electric power industry, etc.



Specifications

- Compact structure, designed to bevel the pipe in the narrow space.
- Pipe out-mounted, self centering, secured clamping, easy to operate.
- Aluminum body, light weight, suitable for working aloft.
- High quality beveling tool, can process different grades of carbon steel, alloy steel, stainless steel and so on.
- More choice for the driven model, electric or pneumatic, widely applicable.
- Apply to pipe end beveling process of water pipe, heater boiler and thermal power plant.
- Electric: Driven by low-energy consumption electric motor 110V or 220V, 50-60Hz
- Pneumatic: Drive by pneumatic motor. Air working pressure: 0.6-0.8Mpa, Air Consuming flux: 650-960L/min

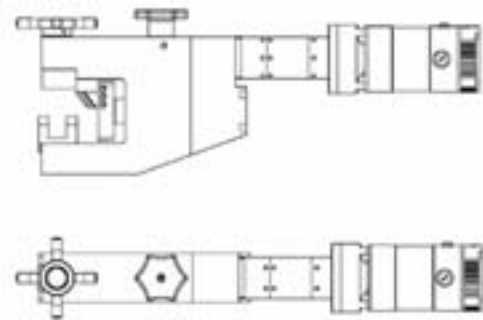

Beveling Types



- other bevel angles or alloy steel, cast steel, please consult us.

Technical Parameter

Model No.	Size	Working range (OD mm)	Wall thickness(mm)	"Tool stroke (mm)"	Rated Power (KW)	Rotating Speed(rpm)
Electric: ISC	53	8-53	≤ 8	0-11	0.9	58
	63	20-63	≤ 12	0-11	0.9	55
	73	25-73	≤ 12	0-11	0.9	54
Pneumatic: TSC	83	30-83	≤ 12	0-11	1.4	43
	108	50-108	≤ 12	0-11	1.4	42

Split Frame Pipe Cutting and Beveling Machine

Product Description

- Split frame technology, easy to install in pipeline.
- Out mounted, clamping by multipoint jaws.
- Cold cutting, don't influence the pipe's material.
- Auto feed, Cutting and Beveling the pipe at the same time, cost effective.
- Variety of beveling shape: "U", "V", "J", double "V" compound bevels.
- Can process material: carbon steel, alloy steel, stainless steel
- Pipeline construction site, beveling process for all the size of pipes & pressure vessels & steam generator.
- Application: petroleum, chemical, natural gas, power supply construction, boiler and nuclear power.
- Four types of driven motors :Electric, Pneumatic, Numerical Controller and Hydraulic.

Beveling Types

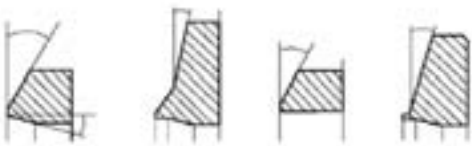

- Other bevel angles or alloy steel, cast steel, please declare before order.

Tools



Standard tools



Optional tools

- Standard tools attached (high speed steel, wall thickness ≤ 25mm), If customers need other degrees cutting tools or wall thickness > 25mm, please inform us before order.

Specifications

- Electric: Driven by low-energy consumption electric motor. 110V or 220V, 50-60Hz
- Pneumatic: Drive by pneumatic motor. Air working pressure: 0.6-0.8Mpa, Air Consuming flux: 650-960L/min

Electric Drive



ISD series

Pneumatic Drive



ISF series

Specifications

- Numerical controller: Driven by the high-power servo motor and PLC control system. Timing range: 0-20 RPM, Power 2.0-5.5KW, 220-230V, 50-60Hz.
- Hydraulic: Driven by hydraulic motor, Rated pressure: 16Mpa, Rate Flux; 25L/min, output torque 260 NM, Electric power: 7.5KW, 380V-3Ph.

Numerical Controller



Machine Body and Material

- Standard Model: Alloy steel with ionic treatment. The weight is a little heavy, but sturdy and durable.
- Light Model: Aerospace grade Aluminum alloy or Hollow-out alloy steel. Light weight and suitable for high-altitude operation.

Hollow-out Alloy Steel



Hydraulic Drive



Aluminum Alloy



Cutting, Drilling and Beveling

Metric Standard

Model No.	Size(mm)	Capacity (OD mm)	Wall thickness(mm)		Rated Power (KW)	Rotating Speed(rpm)
			Light duty	Heavy duty		
Light-duty: Electric:ISD Pneumatic:ISF	80	φ10-80	≤25		1.4	34
	150	φ65-150	≤25		1.4	26
	300	φ150-300	≤25	≤110	1.4	24
	450	φ300-450	≤25	≤110	1.4	22
	600	φ450-600	≤25	≤110	2	15
	750	φ600-750	≤25	≤110	2	14
	830	φ680-830	≤25	≤110	2	13
	900	φ750-900	≤25	≤110	2	12
	1050	φ900-1050	≤25	≤110	2	12
	1160	φ980-1160	≤25	≤110	2	11
Heavy-duty: Electric:ISDH Pneumatic:ISFH NC: SKDH Hydraulic:HYDH	1240	φ1040-1240	≤25	≤110	2	10
	1300	φ1150-1300	≤25	≤110	2	10
	1500	φ1300-1500	≤25	≤110	3	8
	1700	φ1500-1700	≤25	≤110	3	8
	1910	φ1700-1910	≤25	≤110	5.5	7
	2100	φ1900-2100	≤25	≤110	5.5	6
	2300	φ2100-2300	≤25	≤110	5.5	4

Machine Body Size

(standard Specifications, if non-standard Specifications, please consult us)

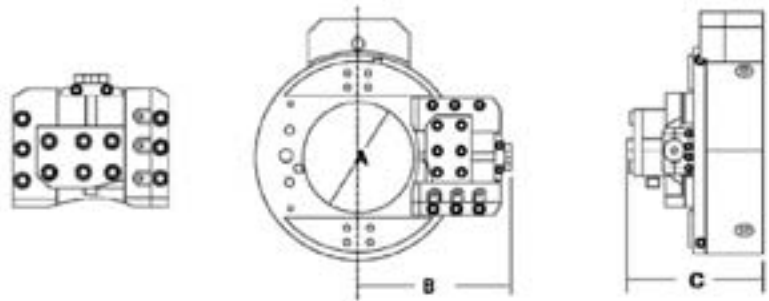

Model No. Specifications	80	150	300	450	600	750	830	900	1050
A(mm)	85	166	306	458	606	753	836	910	1160
B(mm)	171	230	309	385	458	532	606	614	688
C(mm)	161	161	175	175	175	175	175	175	175

Model No. Specifications	1160	1240	1300	1500	1700	1910	2100	2300
A(mm)	1170	1250	1310	1510	1710	1920	2110	2310
B(mm)	772	784	836	934	1036	1140	1244	1344
C(mm)	221	221	221	221	221	221	221	221

British Standard

Model No.	Size(mm)	Capacity (OD mm)	Wall thickness(mm)		Rated Power (KW)	Rotating Speed(rpm)
			Light duty	Heavy duty		
Light-duty:	168	1"-6"	≤25		1.4	24
	219	2"-8"	≤25		1.4	23
Electric:ISD	273	4"-10"	≤25	≤110	1.4	23
Pneumatic:ISF	323	6"-12"	≤25	≤110	1.4	23
NC:SKD	355	8"-14"	≤25	≤110	2.0	23
Hydraulic:HYD	406	10"-16"	≤25	≤110	2.0	22
	457	12"-18"	≤25	≤110	2.0	20
Heavy-duty:	508	14"-20"	≤25	≤110	2.0	20
	555	16"-22"	≤25	≤110	2.0	14
Electric:ISDH	610	18"-24"	≤25	≤110	2.0	14
Pneumatic:ISFH	762	24"-30"	≤25	≤110	2.0	13
NC: SKDH	914	30"-36"	≤25	≤110	2.0	11
Hydraulic:HYDH	1066	36"-42"	≤25	≤110	2.0	10
	1220	42"-48"	≤25	≤110	3.0	9

Machine Body Size

(standard Specifications, if non-standard Specifications, please consult us)

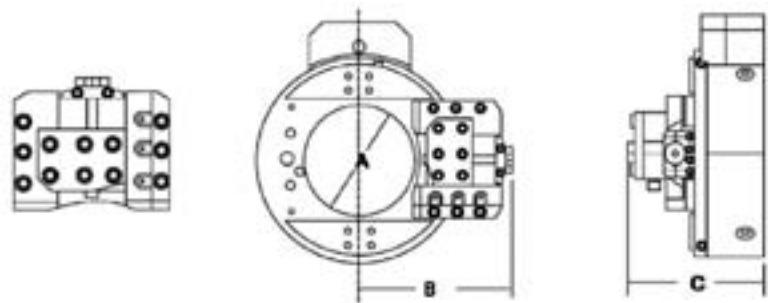

Model No.	168	219	273	323	355	406	457
A(mm)	176	227	281	333	365	420	471
B(mm)	243	269	296	322	338	365	390
C(mm)	175	175	175	175	175	175	175

Model No.	508	555	610	762	914	1066	1220
A(mm)	516	565	620	770	930	1080	1240
B(mm)	413	475	502	577	653	728	837
C(mm)	175	175	175	175	175	221	221

Cutting, Drilling and Beveling

T-Type Beveling Machine

Product Description

- Inner mounted quickly and easily, self located in center of the pipe.
- Beveling and grooving with high speed, light weight, good rigidity. Used for the welding preparation.
- Can process facing, flange, convex surface and seal groove.
- Cold cutting process will not influence the quality of the material of the pipe.
- High quality beveling tool, can process different grades of carbon steels, alloy steel, stainless steel and so on.
- Can process the U, V and J shape of pipe beveling according to the requirements.

Specifications

- Electric: Driven by low-energy consumption electric motor 110V or 220V optional, 50-60Hz
- Pneumatic: Drive by pneumatic motor. Air working pressure:0.6-0.8Mpa, Air Consuming flux:650-960L/min

Beveling Types



- other bevel angles or alloy steel, cast steel, please declare before order

Technical Parameter

Model No.	Size	Working Range (ID mm)	Wall Thickness (mm)	Rated power (KW)	Rotating Rate (rpm)
Electric:SDC	28T	16-28	≤ 15	0.9	58
	80T	28-76	≤ 15	0.9	55
	120T	45-93	≤ 20	1.4	42
	150T	65-159	≤ 20	1.4	34
Pneumatic: TCM	350T	150-330	≤ 20	1.4	16
	30TN	12-30	≤ 15	0.9	58
	90TN	25-90	≤ 15	1.4	42



Electric

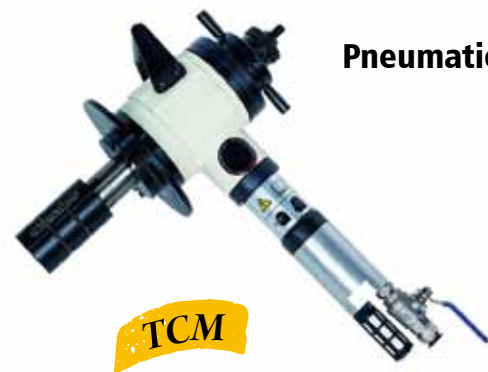

Pneumatic



Y-Type Beveling Machine

Product Description

- The Beveling Machine adopts “Y” shape struction design, minimal radial space, light weight, easy to carry, safe use.
- Inner mounted quickly and easily, self located in center of the pipe.
- Beveling and grooving with high speed, light weight, good rigidity. Used for the welding preparation.
- Can process facing, flange, convex surface and seal groove.
- Cold cutting process will not influence the quality of the material of the pipe.
- High quality beveling tool, can process different grades of carbon steels, alloy steel, stainless steel and so on.
- Can process the U, V and J shape of pipe beveling according to the requirements.

Beveling Types



- other bevel angles or alloy steel, cast steel, please declare before order

Specifications

- Electric: Driven by low-energy consumption electric motor 110V or 220V optional, 50-60Hz
- Pneumatic: Driven by pneumatic motor. Air working pressure:0.6-0.8Mpa, Air Consuming flux:650-960L/min



Technical Parameter

Model No.	Size	Capacity (ID mm)	Wall thickness(mm)	Rated Power (KW)	Rotating Speed(rpm)
Electric: ISY	150	65-159	≤ 15	1.4	34
	250	80-240	≤ 15	1.4	16
	351	150-330	≤ 15	1.4	14
Pneumatic: TCM	630	300-600	≤ 15	1.4	10
	850	600-820	≤ 15	2.0	9

Model No.	Size	Capacity (ID mm)	Wall thickness(mm)	Rated Power (KW)	Rotating Speed(rpm)
Electric: ISY	250-II	80-240	≤ 75	1.4	16
	351-II	150-330	≤ 75	1.4	14
Pneumatic: TCM	630-II	300-600	≤ 75	1.4	10
	850-II	600-820	≤ 75	2.0	9